



DATA SHEET

LIGHTEK WOOD-ALUMINIUM RANGE
TRIPLE GLAZING 48mm



CARPINTEK[®]

TECHNOLOGY CARPENTRY

LIGHTEK WOOD-ALUMINIUM

Mixed wood-aluminum windows Lightek system 68mm. 80 mm frame profile. Sheet metal profile of 68 mm thickness with peripheral snap-in system. Air permeability CLASS 4 according to UNE EN 1026 (2001), watertightness CLASS E-1200 according to UNE EN 1027 (2001), wind load resistance CLASS C 4. Sound insulation 38 Rw (dB). Perimeter locking hardware system with 12 and 13mm vandal-proof groove.

Window type	Wood-aluminium
Timber	Laminated pine Uf average=1,3 W/m2 K
Leaf thickness	68 mm
Glass capacity	80 mm
Width Section	88 mm
Central Section	102,5 mm
Ug	1,1 W/m²K
Thermal insulation	0,87 W/m²K
Sound insulation	45dB
Type of glass	6,25 BE/16 ARGON/4 BE/16 ARGON/6,25 BE
Type of fittings	Safety tilt and turn

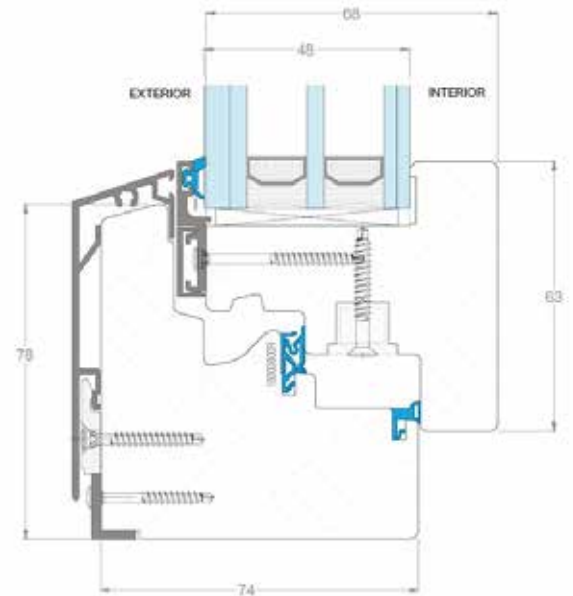

OPENING POSSIBILITIES	
Fixed	
Windows and patio doors	
Oscillating Parallel	

Calculation of the thermal transmission coefficient	UNE EN ISO 10077-2/2007
---	-------------------------

Air permeability CLASS 4 according to the standard - UNE EN 1026 (2001)
UNE EN 12207 (2000)

Watertightness CLASS 9A according to the standard - UNE EN 1027 (2001)
UNE EN 12208 (2000)

Resistance to wind load CLASS C4 according to the standard - UNE EN 12211 (2001) UNE EN 12210 (2000) - CE marking (Standard for windows and exterior pedestrian doors UNE-EN 14351-1)

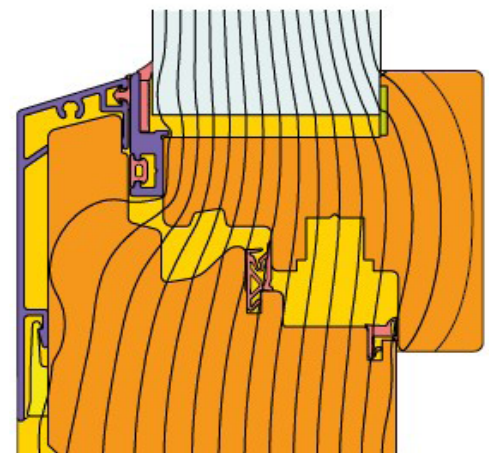

The background is a detailed architectural floor plan, likely for a building's second floor, showing various rooms, corridors, and structural elements. A pencil is positioned diagonally across the drawing, pointing towards the bottom left. The drawing includes numerous dimension lines, room labels such as '103 P1-P2-P3' and '104 P1-P2', and elevation markers like '+1.250' and '0.000'. The overall aesthetic is technical and professional.

TECHNICAL DRAWINGS

LIGHTEK WOOD-ALUMINIUM RANGE

TRIPLE GLAZING 48mm

 **CARPINTEK[®]**
TECHNOLOGY CARPENTRY

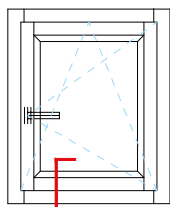
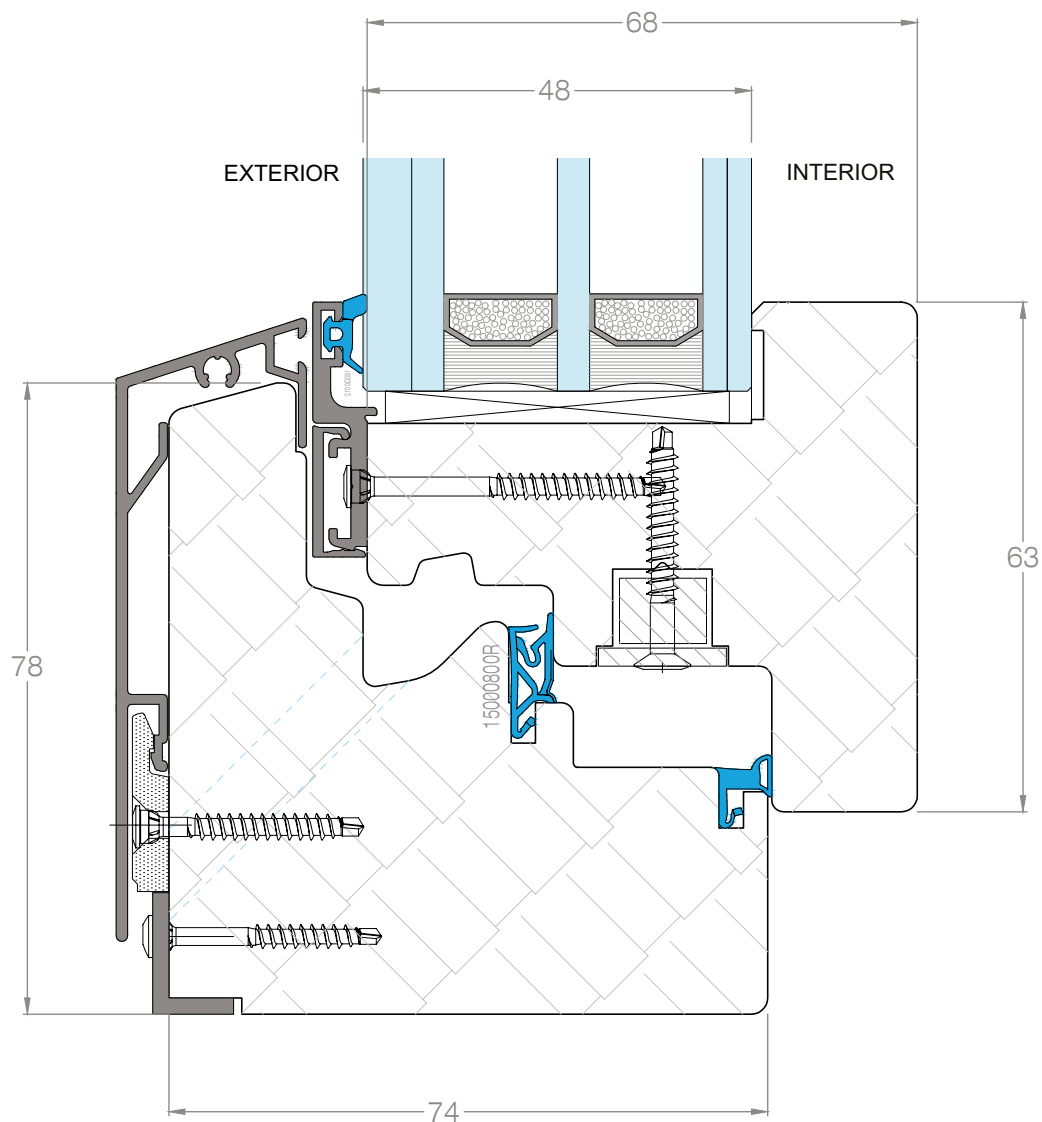

Carpintek Group
 Calle, Camino Mejorada, 7, 28850
 Torrejón de Ardoz, Madrid. España

LighTEK 68 Mixto

P.MARCO 68 x 63 P.HOJA 74 x 78

V^B

TECNICO Aurelien Chevalot

CODIGO LTA69P/OB1

00A/01

APERTURA PRACTICABLE / OB

ESC. 1.5 : 1 REV. 01

FECHA 03/03/21

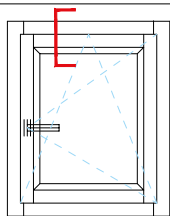
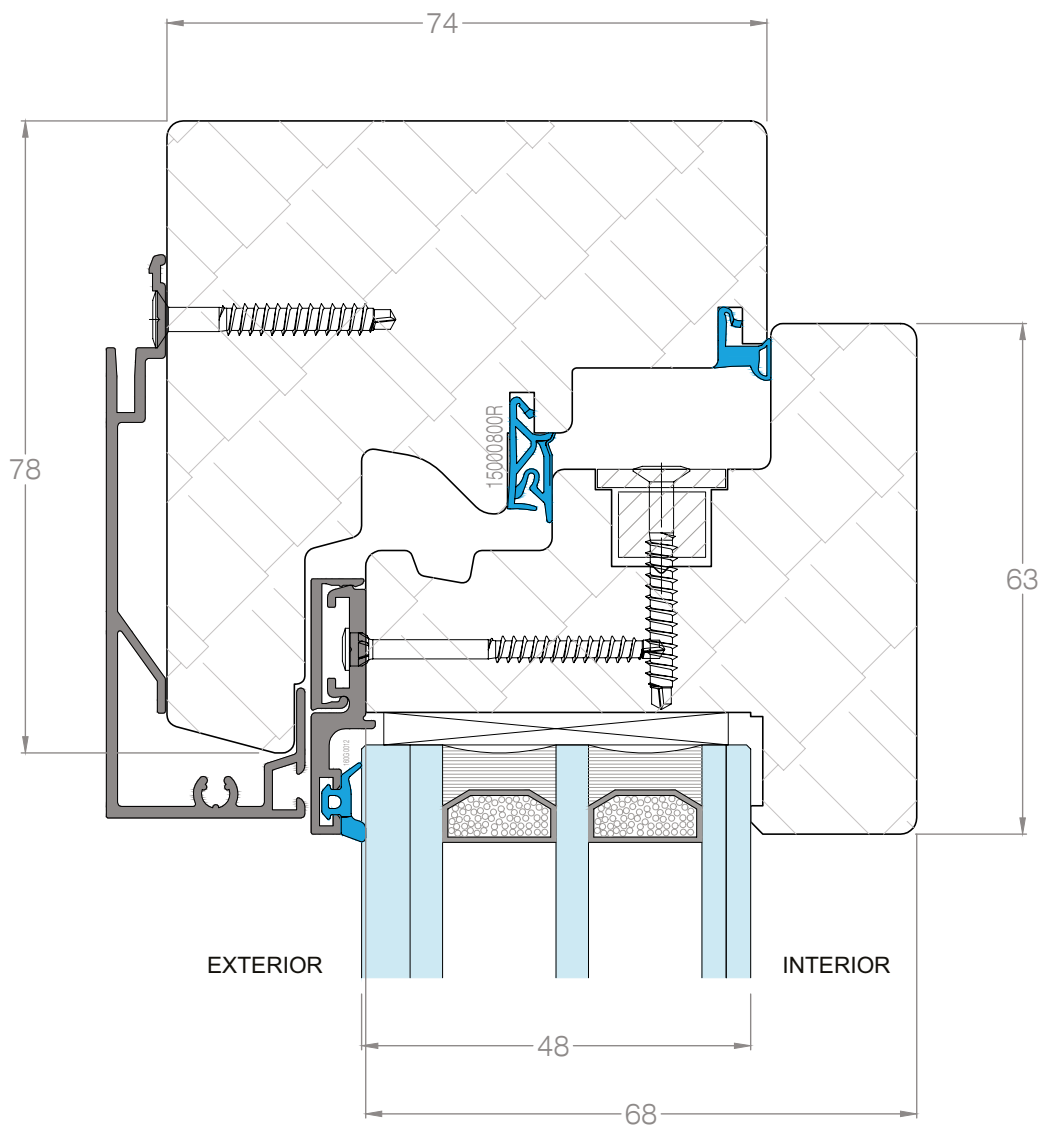

Carpintek Group
 Calle, Camino Mejorada, 7, 28850
 Torrejón de Ardoz, Madrid, España

LighTEK 68 Mixto

P.MARCO 68 x 63 P.HOJA 74 x 78

VFB*

TECNICO Aurelien Chevalot

CODIGO LTA69P/OB1

00A/01

APERTURA PRACTICABLE / OB

ESC. 1.5 : 1 REV. 01

FECHA 03/03/21

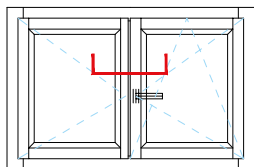
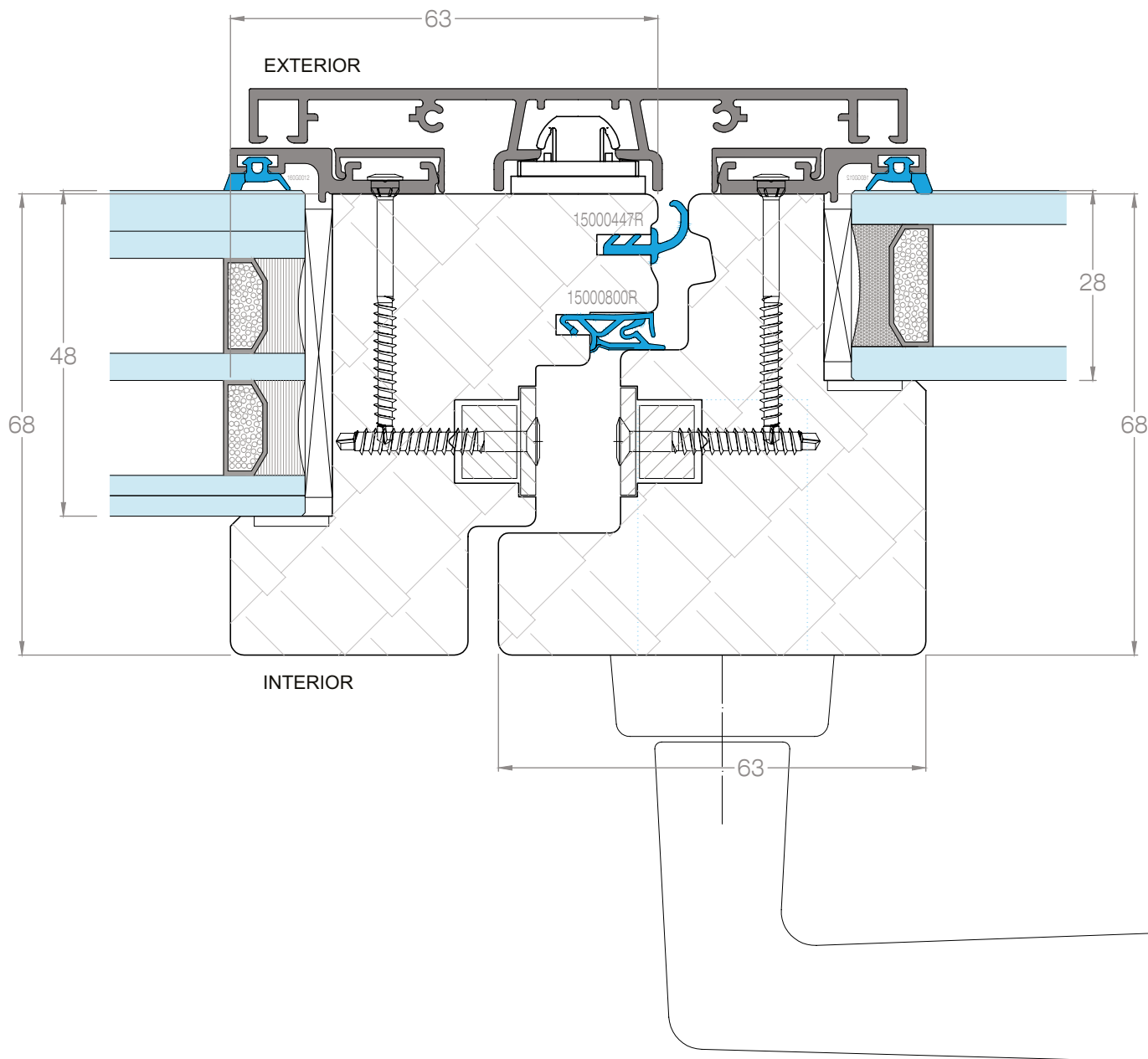

Carpintek Group
 Calle, Camino Mejorada, 7, 28850
 Torrejón de Ardoz, Madrid. España

LighTEK 68 Mixto

P.MARCO 68 x 63 P.HOJA 74 x 78

V/Bº

TECNICO Aurelien Chevalot

CODIGO LTA69P/OB2

00A/01

APERTURA. PRACTICABLE / OB

ESC. 1.5 : 1 REV. 01

FECHA 03/03/21



CARPINTEK GROUP
Phone: +34 910 088 018 Web: www.carpintek.com Email: comercial@carpintek.es

Our raw material is sourced from domestic producers and is certified by the Forest Stewardship Council® (FSC®), which ensures responsible wood management, and the Programme for the Endorsement of Forest Certification™ (PEFC™), which promotes sustainable forest management to achieve social, economic and environmental balance.

